

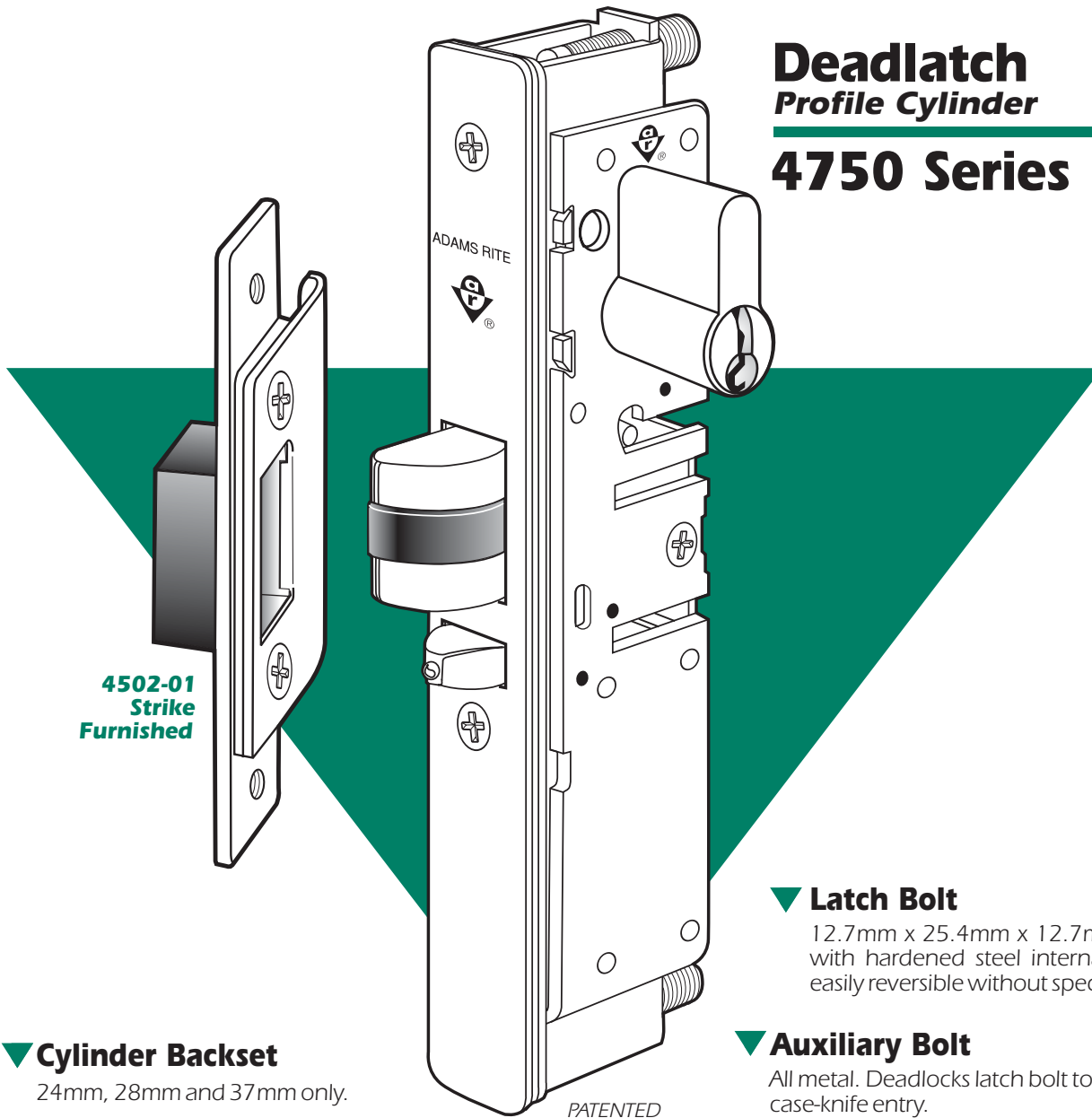

## Deadlatch Profile Cylinder 4750 Series



**4502-01  
Strike  
Furnished**

### ▼ Cylinder Backset

24mm, 28mm and 37mm only.

### ▼ Case

Steel with corrosion-resistant plating. 25.4mm x 173mm x depth. (Depth varies by backset. See table on back page.)

### ▼ Function

Flexibility of traffic control during and after business hours is offered by 4750 Series Deadlatches. A reverse turn of the key while bolt is held retracted retains the bolt, to allow two-way traffic for hospitals, banks, stores and other buildings which require free entrance at certain times and key-only or exit-only at other times. Uses any standard 17mm profile cylinder or "half-cylinder" with thumbturn.

### ▼ Latch Bolt

12.7mm x 25.4mm x 12.7mm throw. All metal with hardened steel internal pins. Handing is easily reversible without special tools.

### ▼ Auxiliary Bolt

All metal. Deadlocks latch bolt to prevent "loiding" or case-knife entry.

### ▼ Strikes

Standard strike furnished is 4502-01 for flat jamb where door closes flush or nearly flush. Also available: radius strike for opposite stile in paired doors; longer strike (4501) to cover slot strike of MS® lock; long lip strikes for centerhung doors. (See page SW-24 and Electric Strike section.)

### ▼ Operation

Turn key or operate turn to retract spring-loaded latch bolt. To hold bolt retracted, push it in and secure by reverse turn of key. (See back page.)



**ADAMS RITE**  
MANUFACTURING CO.

260 Santa Fe Street  
Pomona, California 91767  
(800) 872-3267 Fax: (800) 232-7329  
www.adamsrite.com



# 4750 Series Deadlatch

## DIMENSIONS

INCHES  
MILLIMETERS

Nominal, subject to tolerance extremes.

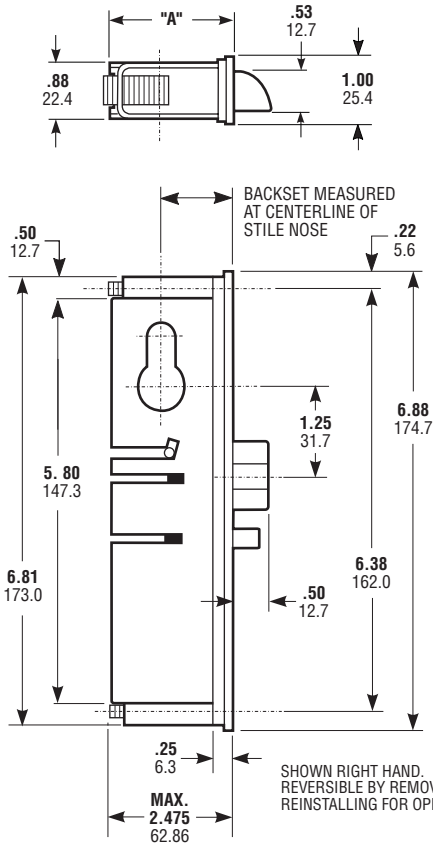

BACKSET	"A"
15/16" 24	1.60 40.6
1-3/32" 28	1.76 44.7
1-15/32" 37	2.14 54.3

ARMORED FACEPLATE 25.4mm x 174.7mm	
FLAT	4750
RADIUS	4751
RADIUS w/WEATHERSTRIP	4751W
RH BEVEL	4752(RH)
LH BEVEL	4752(LH)

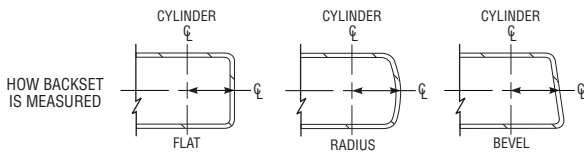

## INSTALLATION

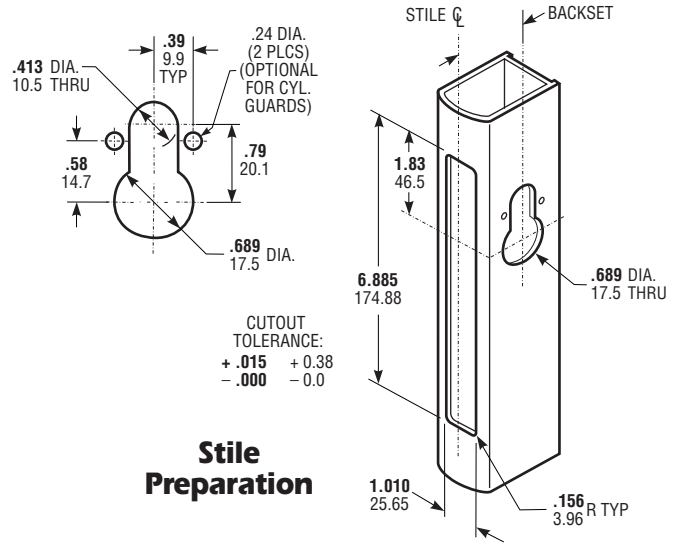

### Stile Preparation

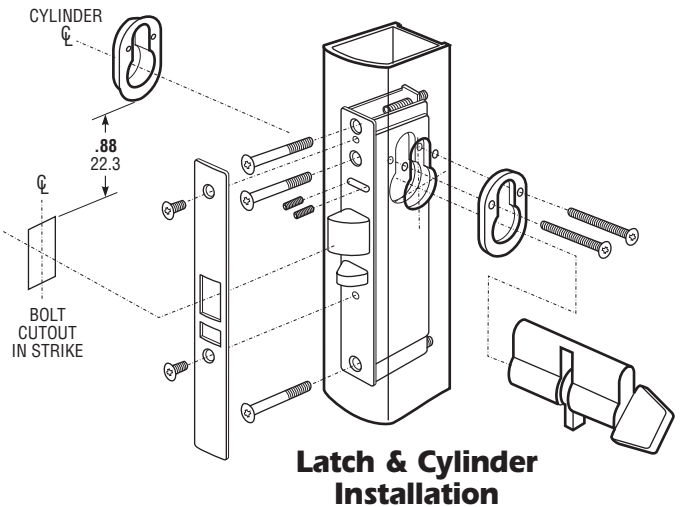

## HOW TO ORDER

Specify quantity and the following information.  
Order related hardware separately.

Faceplate Shape	Backset	Handing
0 Flat	2 24mm	5 LH or RHR
1 Radius	3 28mm	6 RH or LHR
1W Radius w/W/strip	4 37mm	
2(RH) Right Bevel		
2(LH) Left Bevel		

**4751-36-201-628**

Strike Size	Strike Shape/Lip Length	Faceplate Finish
1 117.6mm (4501)*	01 Flat/Standard Jamb	628 Clear Anodized
2 66.8mm (4502)*	02 Radius/Standard Stile	313 Dark Bronze Anod.
	17 Flat/Centerhung 4.0" Jamb	335 Black Anod.
	21 Flat/Centerhung 4.5" Jamb	
	XX Other Lip lengths	

\*See pg SW-26  
For other available finishes, contact factory.

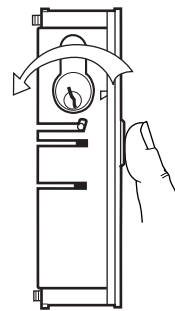

### Bolt Holdback

A reverse turn of the key (while bolt is held fully retracted) retains the bolt, allowing the door to be free swinging.

## OPTIONS

Backset, Faceplate Shape, Finish, Strike and Handing must be specified when ordering.

## STANDARD PACKAGE

Individually boxed with strike and machine screws for mounting. Cylinders available at extra cost. Shipping weight: 1-1/4 lbs. Also available in a 25 unit pack for volume users.